

Swivel/linear unit

DSL-32-25-270-P-S20-CR

Part number: 163102

FESTO

For proximity sensing. Rotary and linear movement can be actuated independently of one another. Rotary movement of 0° - 270° infinitely adjustable.

The maximum rotary angle play at the piston rod is 2°. When mounting additional components on the drive shaft, never exceed the maximum permitted tightening torque of 5.5 Nm.

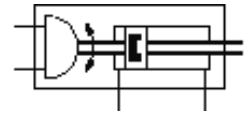
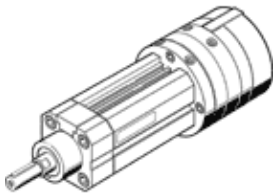

Data sheet

Feature	Value
Cushioning angle	12.5 deg
Rotation angle adjustment range	270 deg
Stroke	25 mm
Piston diameter	32 mm
Swivel angle	258 deg
Cushioning	CR: shock absorber right P: Flexible cushioning rings/plates at both ends
Assembly position	Any
Fine adjustment	1.5 deg
Mode of operation	double-acting
Design structure	Rotary vane
Position detection	For inductive sensors For proximity sensor
Variants	S20: through, hollow piston rod
Protection against torque/guide	with plain-bearing guide
Operating pressure	2.5 ... 8 bar
Max. impact speed	500 mm/s
Max. swivel frequency at 6 bar	0.7 Hz
Operating medium	Dried compressed air, lubricated or unlubricated
Ambient temperature	-10 ... 60 °C
Cushioning length	8 mm
Torque at 6 bar	10 Nm
Theoretical force at 6 bar, return stroke	294 N
Theoretical force at 6 bar, advance stroke	422.5 N
Permissible mass moment of inertia	0.0021 kgm ²
Additional weight per 10 mm stroke	109 g
Basic weight for 0 mm stroke	3,000 g
Mounting type	Clamped in T-slot with external (male) thread Optional
Pneumatic connection	G1/8
Materials information for cover	Wrought Aluminium alloy Anodised
Materials information for seals	TPE-U(PU)
Materials information, housing	Wrought Aluminium alloy Smooth anodised
Materials information for piston rod	Heat-treatment steel