

twin-piston cylinder

DPZJ-32-80-P-A-KF-S20

Part number: 162163

FESTO

With two parallel, double-ended piston rods and yoke plates, for proximity sensing, with elastic cushioning rings in end positions.

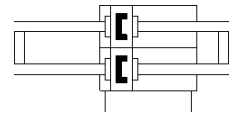
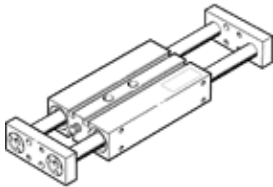

Data sheet

| Feature | Value |
|--|---|
| Stroke | 80 mm |
| Adjustable end-position range/length | 10 mm |
| Piston diameter | 32 mm |
| Operating mode of drive unit | Yoke |
| Cushioning | P: Flexible cushioning rings/plates at both ends |
| Assembly position | Any |
| Guide | Recirculating ball bearing guide |
| Design structure | Guide |
| Position detection | For proximity sensor |
| Variants | through, hollow piston rod |
| Operating pressure | 1 ... 10 bar |
| Max. speed | 1 m/s |
| Mode of operation | double-acting |
| Operating medium | Compressed air in accordance with ISO8573-1:2010 [7:4:4] |
| Note on operating and pilot medium | Lubricated operation possible (subsequently required for further operation) |
| Corrosion resistance classification CRC | 0 |
| Ambient temperature | -20 ... 80 °C |
| Impact energy in end positions | 0.5 Nm |
| Theoretical force at 6 bar, return stroke | 724 N |
| Theoretical force at 6 bar, advance stroke | 724 N |
| alternative connections | See product drawing |
| Pneumatic connection | G1/8 |
| Materials information for cover | Wrought Aluminium alloy |
| Materials information for seals | NBR |
| Materials information, housing | Wrought Aluminium alloy |
| Materials information for piston rod | Case-hardened steel |