

twin-piston cylinder

DPZJ-32-50-P-A-KF-S20

Part number: 162162

FESTO

With two parallel, double-ended piston rods and yoke plates, for proximity sensing, with elastic cushioning rings in end positions.

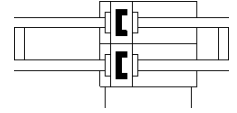
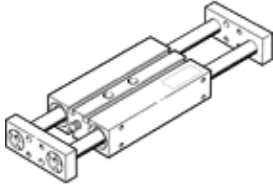

Data sheet

Feature	Value
Stroke	50 mm
Adjustable end-position range/length	10 mm
Piston diameter	32 mm
Operating mode of drive unit	Yoke
Cushioning	P: Flexible cushioning rings/plates at both ends
Assembly position	Any
Guide	Recirculating ball bearing guide
Design structure	Guide
Position detection	For proximity sensor
Variants	through, hollow piston rod
Operating pressure	1 ... 10 bar
Max. speed	1 m/s
Mode of operation	double-acting
Operating medium	Compressed air in accordance with ISO8573-1:2010 [7:4:4]
Note on operating and pilot medium	Lubricated operation possible (subsequently required for further operation)
Corrosion resistance classification CRC	0
Ambient temperature	-20 ... 80 °C
Impact energy in end positions	0.5 Nm
Theoretical force at 6 bar, return stroke	724 N
Theoretical force at 6 bar, advance stroke	724 N
alternative connections	See product drawing
Pneumatic connection	G1/8
Materials information for cover	Wrought Aluminium alloy
Materials information for seals	NBR
Materials information, housing	Wrought Aluminium alloy
Materials information for piston rod	Case-hardened steel