

compact cylinder

EMM-25-10-P-A

Part number: 158628

FESTO

For proximity sensing, with end position cushioning, numerous mounting options.

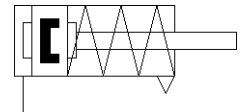
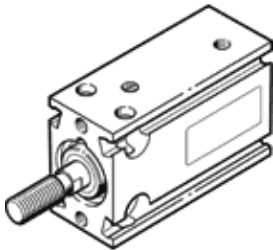

Data sheet

Feature	Value
Stroke	10 mm
Piston diameter	25 mm
Cushioning	P: Flexible cushioning rings/plates at both ends
Assembly position	Any
Mode of operation	single-acting pushing action
Design structure	Piston Piston rod Profile barrel
Position detection	For proximity sensor
Variants	Single-ended piston rod
Operating pressure	1.5 ... 10 bar
Operating medium	Compressed air in accordance with ISO8573-1:2010 [7:4:4]
Note on operating and pilot medium	Lubricated operation possible (subsequently required for further operation)
Corrosion resistance classification CRC	2 - Moderate corrosion stress
Ambient temperature	-20 ... 80 °C
Tightening torque of the drive mounting	8 Nm +10%
Theoretical force at 6 bar	227 N
Theoretical force at 6 bar, advance stroke	227 N
Mounting type	Optional with through hole with internal (female) thread
Pneumatic connection	M5
Material cover	Brass
Material seals	TPE-U(PU)
Material housing	Wrought Aluminium alloy Anodised
Material piston rod	High alloy steel, non-corrosive